

# Produkt-Datasheet MSG

## Brass-ball valve for gas (with yellow steel lever)



**von Scheven**

Armaturenfabrik und Apparatebau

E	V30
	001
	state 08/06

**Rudolf von Scheven GmbH**  
Wuppertaler Str. 10-12 45549 Sprockhövel  
www.von-scheven.com

**Tel.** + 49 (0)23 24 / 97 42 - 0  
**Fax** + 49 (0)23 24 / 97 42 - 10  
**eMail** sales@von-scheven.com

### brass ball valve for gas (with yellow steel lever)

DN 10 - 50

PN max. 5 bar



#### Technical description

The brass-ball valve type MSG is for all technicals applications with a max. nominal pressure of up to 40bar. The use with inflammable gas is possible for a working pressure of up to 5bar. The application area is in particular defined by the used materials. The spindle seal is a maintenance-free o-ring.

#### Application area:

For non-aggressive fluids and gases. Furthermore, the resistiveness against the flow medium generally has to be given.

#### type series

06 – with female thread on both sides acc. to UNI ISO 7

#### materials

body: brass nickel-plated  
ball: brass hard-chrome plated  
spindel: brass hard-chrome plated  
Kugeldichtungen: PTFE  
Spindeldichtung: NBR / FPM

#### Approvals

DVGW for gas Druckstufe: PN 5

**Allowed operating temperature:** -20 °C up to +60 °C

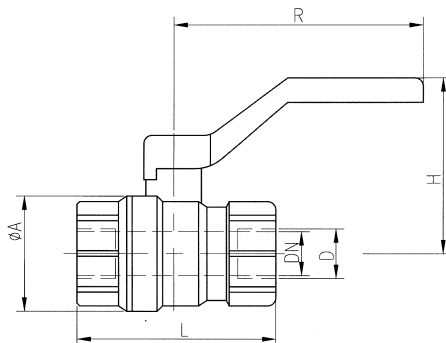

#### Technical data type serie 06 (female thread on both sides acc. to UNI ISO 7)

DN	Lichte Weite	PN	D	L	R	H	weight (kg)
10	11	5	3/8 "	48	83	43	0,20
15	15	5	1/2 "	58	83	43	0,25
20	20	5	3/4 "	70	83	47	0,35
25	25	5	1 "	83	90	64	0,55
32	32	5	1 1/4 "	97	110	69	0,90
40	40	5	1 1/2 "	106	130	79	1,25
50	50	5	2 "	131	190	110	1,90

Ordering example: ball valve Type MSG DN15 with female thread acc. to DIN 2999  
⇒ MSG 15 06

Depending on the design, not all positions are used with every nominal diameter. In special types, several parts may be made of different materials. Flanged ball valves with turnable flanges are available in DN 15 up to DN 50.

If you have other demands, different from the here specified standard operational conditions, please feel free to request them separately.

The operating and maintenance manual and in particular the safety instructions have to be followed. They can be downloaded from [www.von-scheven.com](http://www.von-scheven.com), as well as certificates and approvals.

All dimensions in mm.  
Technical changes reserved.