

Product-Datasheet MSK

Brass-ball valve (with red steel lever)



von Scheven

Armaturenfabrik und Apparatebau

E	V030
	000
	state 08/06

Rudolf von Scheven GmbH
Wuppertaler Str. 10-12 45549 Sprockhövel
www.von-scheven.com

Tel. + 49 (0)23 24 / 97 42 - 0
Fax + 49 (0)23 24 / 97 42 - 10
eMail sales@von-scheven.com

Ball valve brass (with red steel lever)

DN 6 - 80
PN max. 40 bar



Technical description

The brass-ball valve type MSK is for all technical applications with a max. nominal pressure of up to 40 bar. The application area is in particular defined by the used materials.

Application area

For non-aggressive fluids and gases. Furthermore, the resistiveness against the flow medium generally has to be given

type serie

06 – female thread on both sides acc. to UNI ISO 7

Materials

body: brass nickel-plated
ball: brass hard-chrome plated
spindel: brass hard-chrome plated
Kugeldichtungen: PTFE
Spindeldichtung: PTFE

Allowed operating temperature: -30 °C up to +150 °C
Differing temperatures on request.

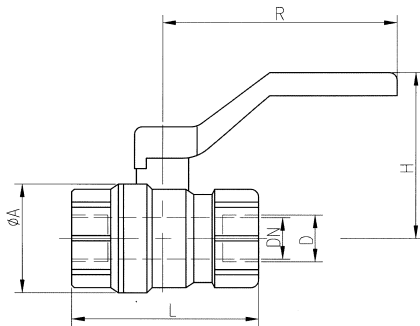

technical data type series 06 (female thread on both sides UNI ISO 7)

DN	Lichte Weite	PN	D	L	R	H	weight (kg)
6	9	40	1/4 "	46	83	42	0,20
10	11	40	3/8 "	48	83	43	0,20
15	15	40	1/2 "	58	83	46	0,25
20	20	40	3/4 "	69	83	49	0,35
25	25	40	1 "	82	90	66	0,55
32	32	40	1 1/4 "	97	110	68	0,90
40	40	40	1 1/2 "	107	130	81	1,25
50	50	40	2 "	131	190	110	1,90
65	63	40	2 1/2 "	155	240	132	3,30
80	76	40	3 "	178	240	141	4,60

Ordering example: ball valve Type MSK DN15 with female thread acc. to DIN 2999
⇒ MSK 15 06

If you have other demands, different from the here specified standard operational conditions, please feel free to request them separately.

The operating and maintenance manual and in particular the safety instructions have to be followed. They can be downloaded from www.von-scheven.com, as well as certificates and approvals.

All dimensions in mm.
Technical changes reserved.